

APPLICATION REFERENCE: PF/20/2368

LOCATION: Land South of Car Park and Public Conveniences, Long Road, Irstead, Norfolk

PROPOSAL: Erection of general purpose agricultural building with associated concrete hardstanding to front, soft landscaping and access



NORTH
NORFOLK
DISTRICT
COUNCIL

north-norfolk.gov.uk

08 April 2021

SITE LOCATION PLAN

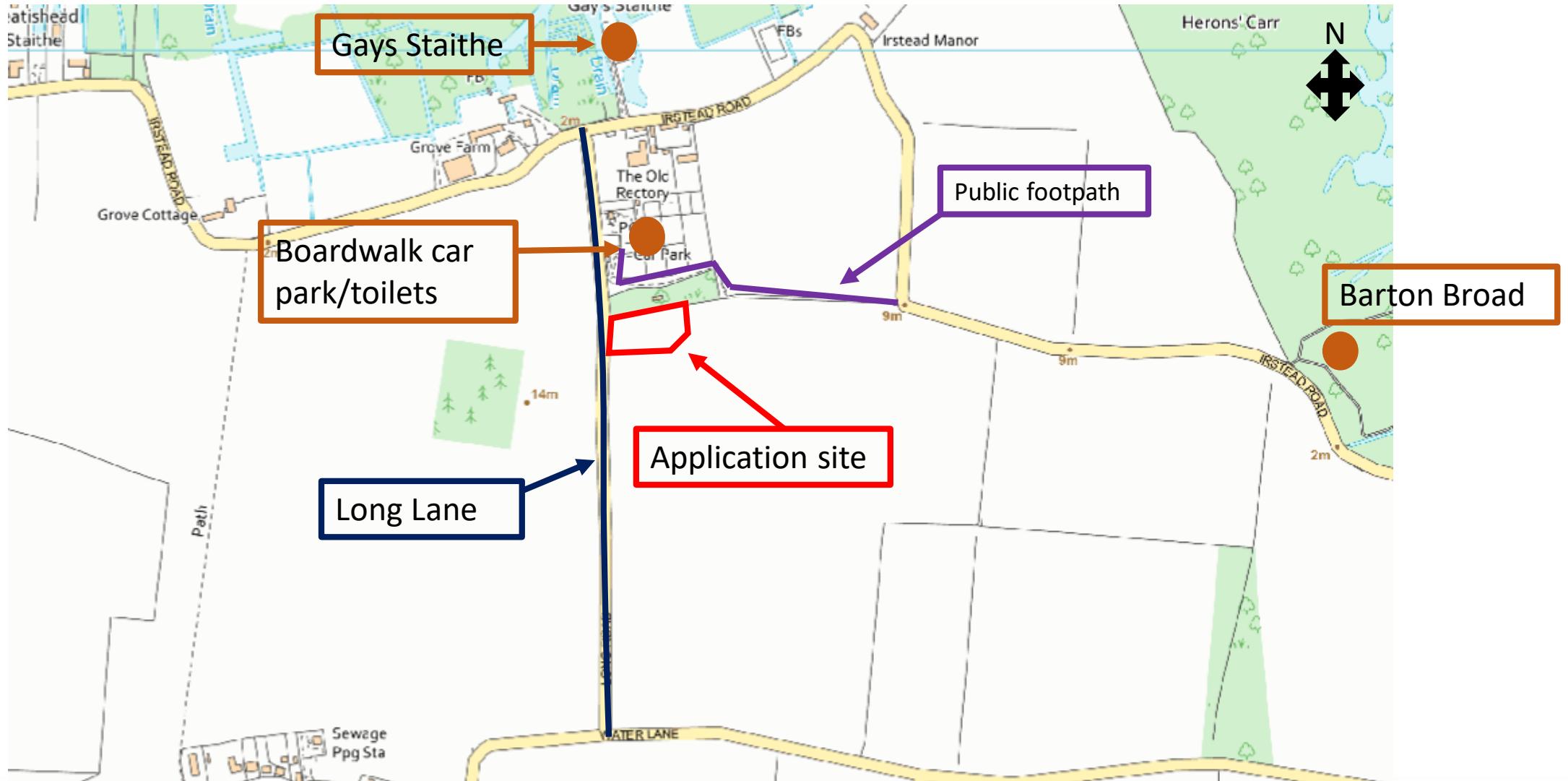

SITE LOCATION PLAN (aerial)

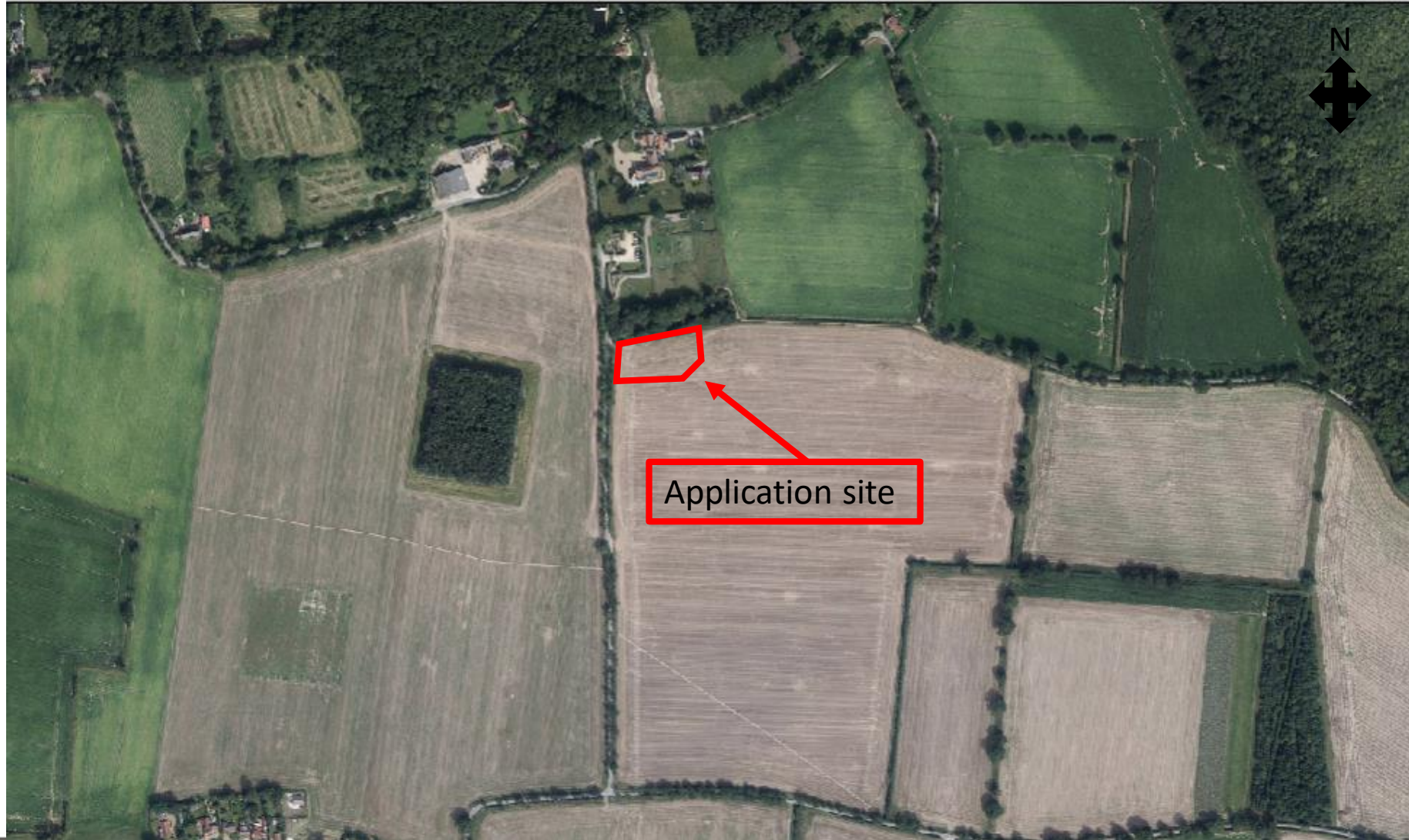

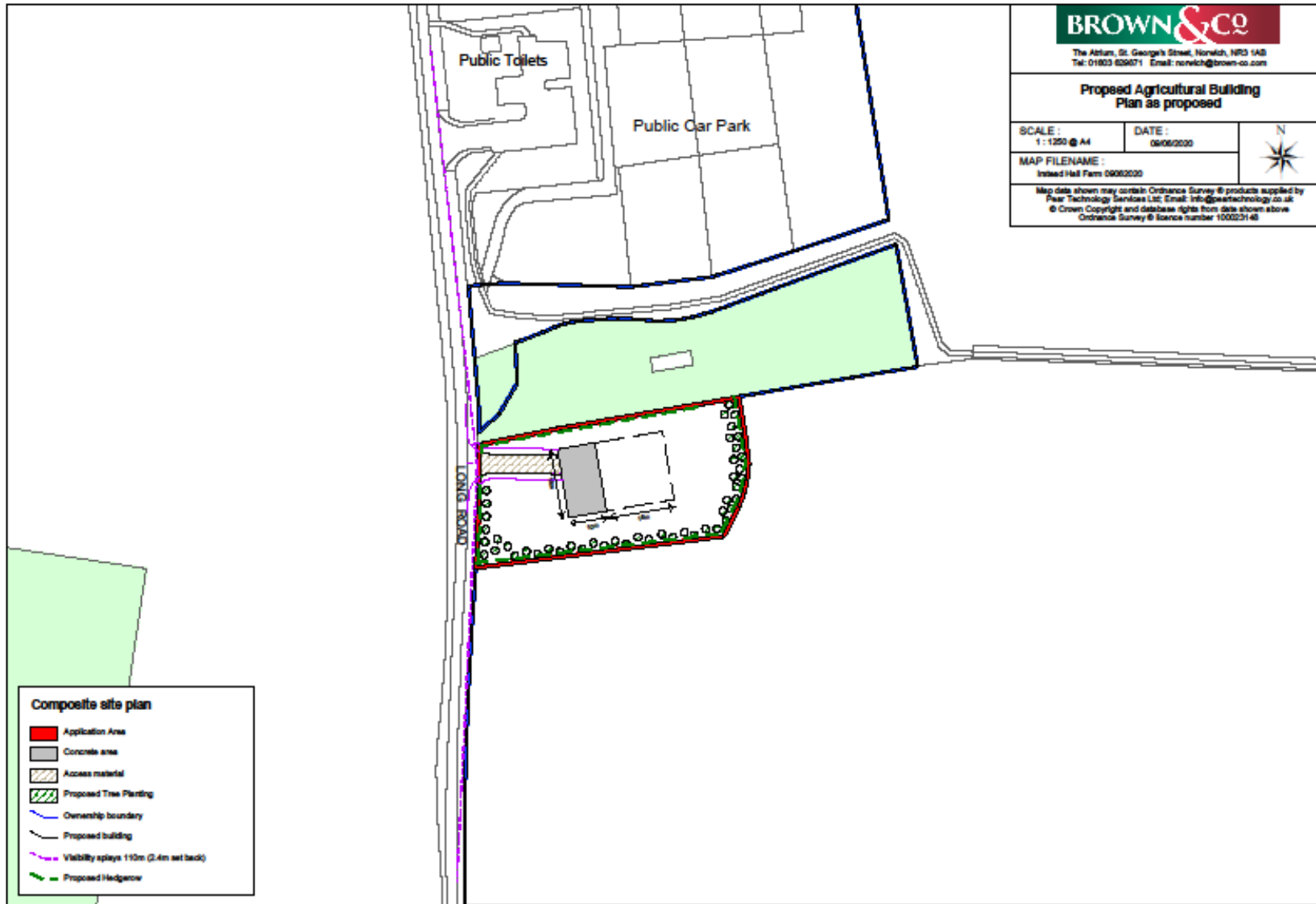





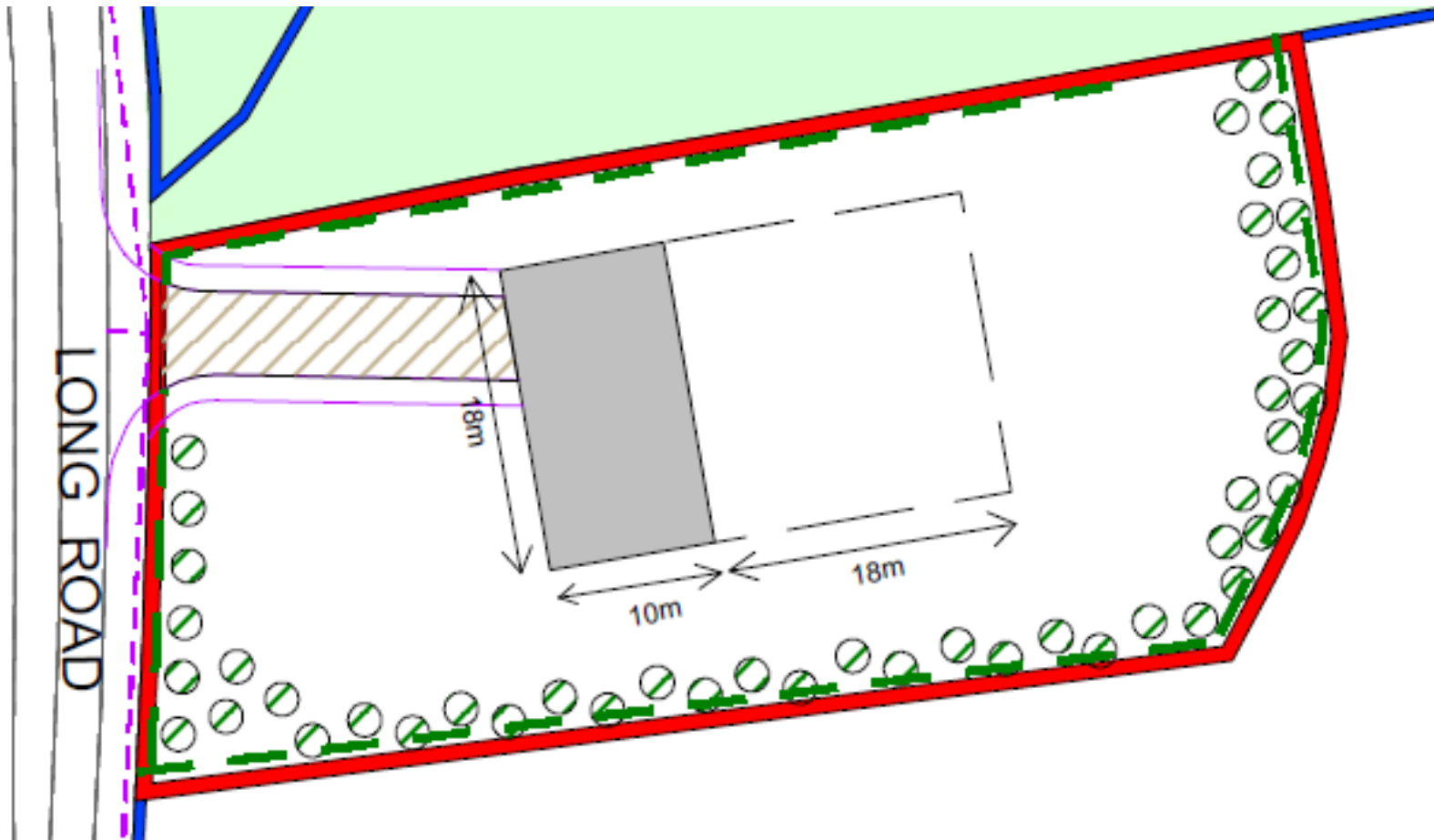



PROPOSED SITE PLAN (with landscaping)

PROPOSED SITE PLAN (with landscaping)



Composite site plan

-  Application Area
-  Concrete area
-  Access material
-  Proposed Tree Planting
-  Ownership boundary
-  Proposed building
-  Visibility splays 110m (2.4m set back)
-  Proposed Hedgerow

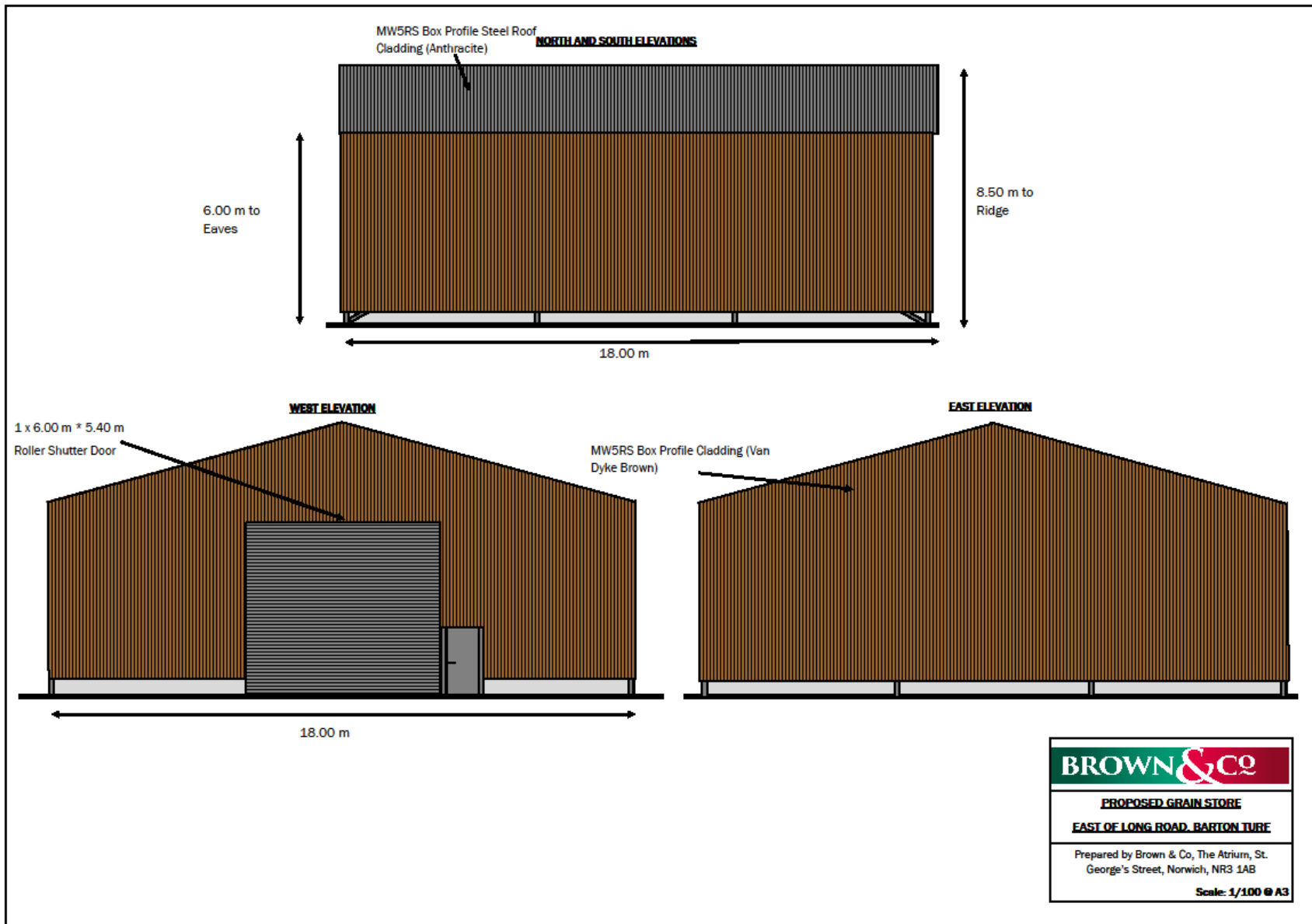

PROPOSED ELEVATIONS

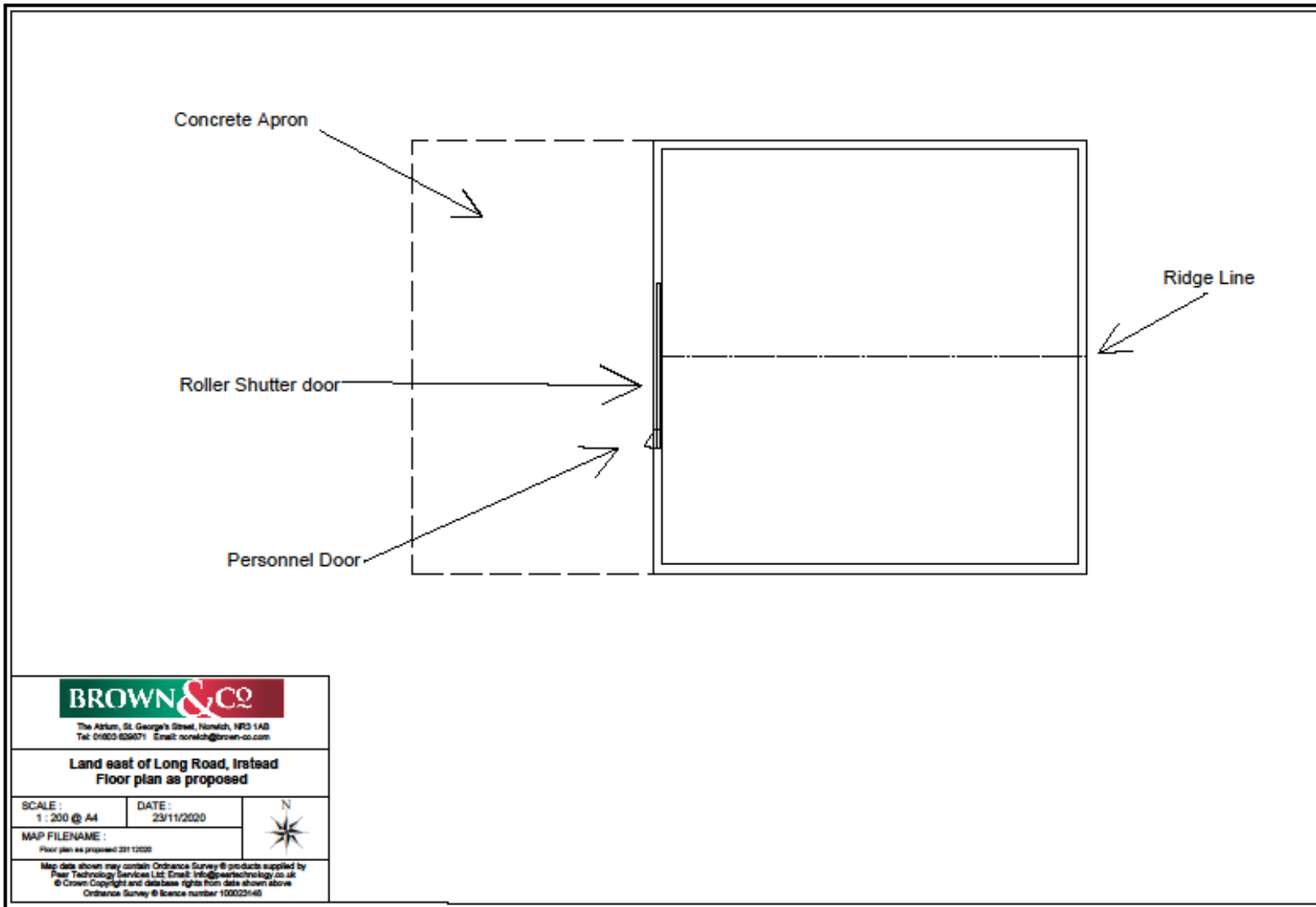

PROPOSED FLOOR PLAN

Site entrance and site

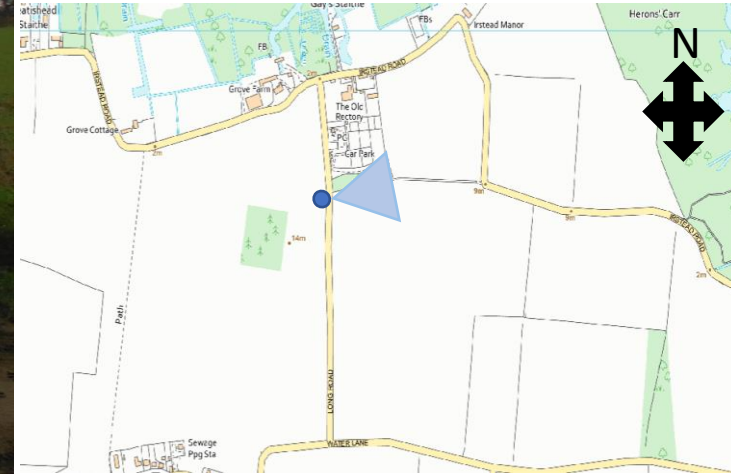



Site entrance

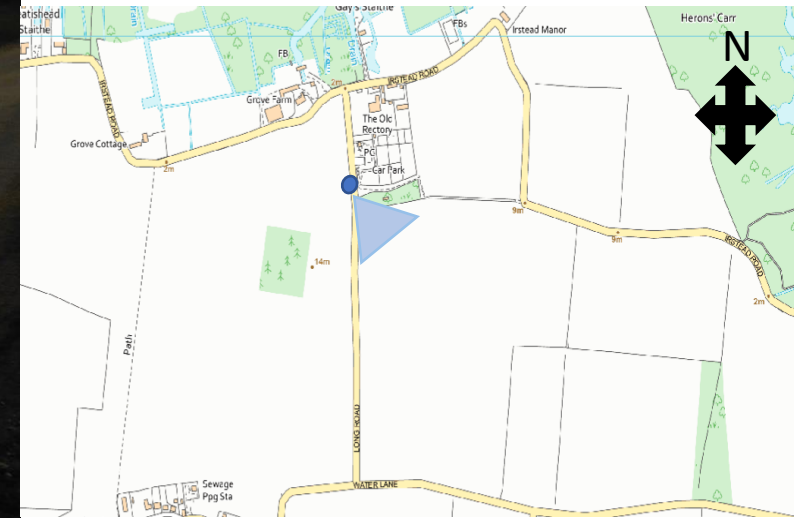



Looking north along Long Lane

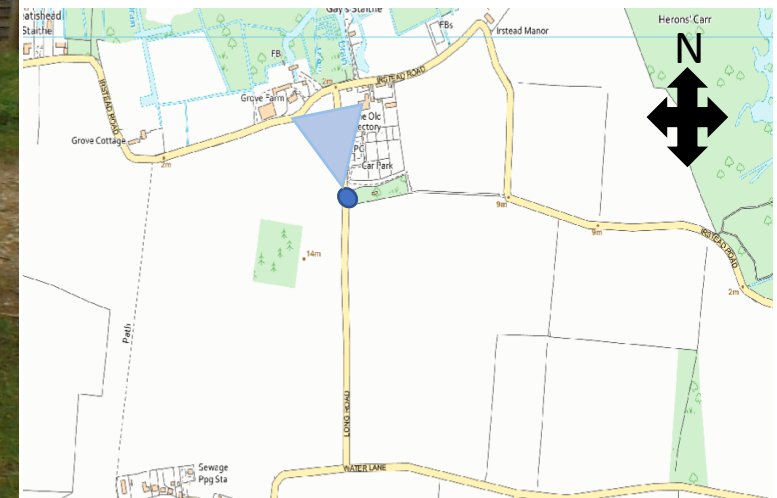



Looking east into site

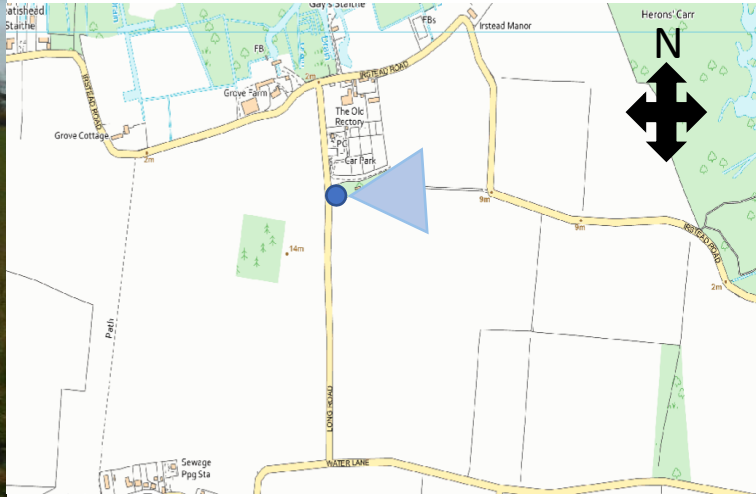



Looking west
back towards site
from footpath

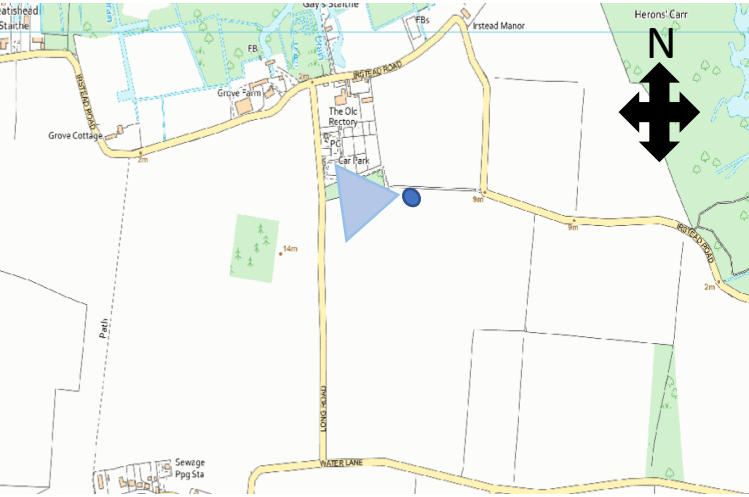



Looking west
back towards
site from end of
footpath

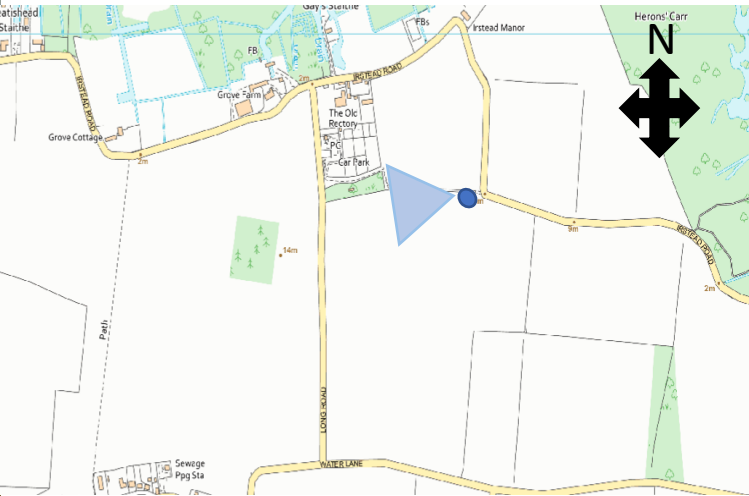



Looking north from Long Lane towards site

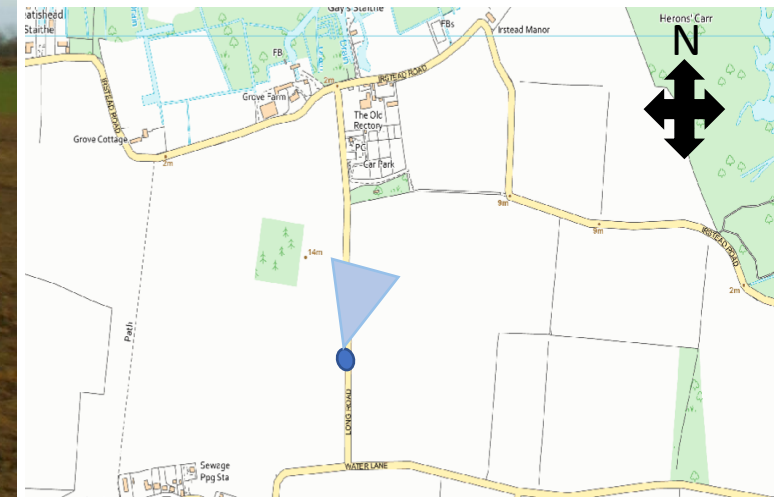



Looking north-east from Long Lane towards site

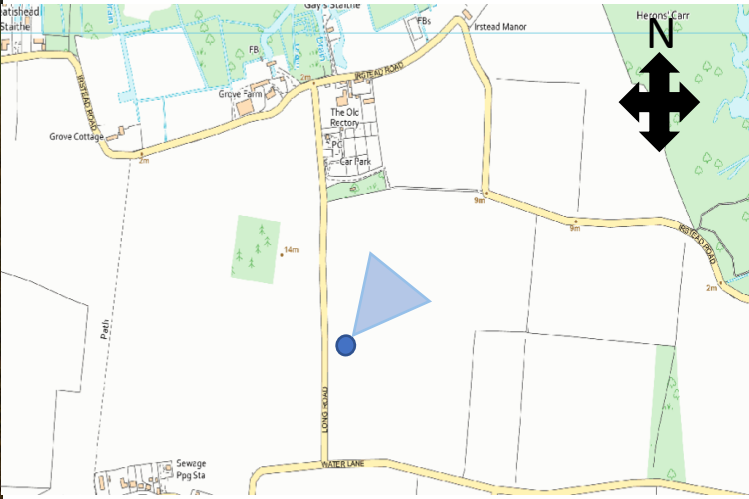

KEY ISSUES

Principle of development

Design and amenity

Highway impact

Landscape impact

Environmental matters

RECOMMENDATION

It is recommended that the application be APPROVED subject to conditions relating to the matters listed below and any others considered necessary by the Assistant Director for Planning:

- Time limit for implementation
- Constructed in accordance with the approved plans
- Materials as approved
- Provision of a detailed landscaping scheme to be carried out during next available planting season
- Landscape Management Plan
- Replacement of new planting if fails
- Access construction details to be agreed
- Prior agreement of any ventilation/air conditioning/refrigeration/mechanical extractor systems or any other plant and equipment
- Prior agreement of any external lighting
- Restrict use to agricultural purposes only
- No external storage of vehicles/equipment/machinery

Final wording of conditions to be delegated to the Assistant Director for Planning.